

# **MDM-5000 DIRECT DRIVE SETS**

## ***PRODUCT GUIDELINES***

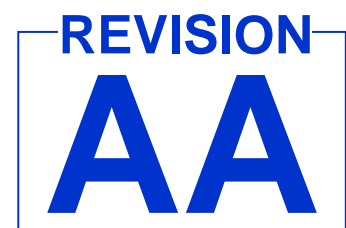

This documentation may not be copied, photocopied, reproduced, translated, or reduced to any electronic medium or machine-readable format without explicit written permission from SLMTI Torque Systems

Copyright © 2016  
SLMTI Torque Systems  
6 Enterprise Road  
Billerica, Ma 01821  
Tele: 978-667-5100  
Fax: 978-600-0280

## **INTRODUCTION**

MDM-5000 Direct Drive Sets have been designed to fit into applications where size and weight are important considerations. They are supplied as two pieces; a cut-core segmented stator and a rotor. The stator is molded in a thin walled aluminum housing using thermally conductive epoxy, which provides excellent heat transfer and protects the windings (and optional integrated Hall board) from damage during installation and handling. The rotor is coated with a polymer shrink wrap which protects the magnets from dislodging during operation and also prevents damage while handling.



## **FEATURES & BENEFITS**

- High performance Brushless design provides zero maintenance
- MDM 5000 technology
  - Cut-core or Segmented Stator Technology
    - High slot-fill winding for high efficiency
  - Stator molded in thin wall aluminum housing using thermally conductive epoxy
    - Excellent heat transfer
    - High torque density
    - Winding and Hall Board (when used) protected from handling damage
  - Rotor protected with polymer shrink wrap
    - Protects magnets from dislodging during operation
    - Handling damage avoided
- High pole count for Low Cogging and Smooth Operation
- High torque to inertia ratio ideal for high acceleration/deceleration mode with rapid start-stop
- Low electrical time constant for Fast Response
- Minimize size & weight simplifies installation
- Maximize rate & position accuracy Direct drive
  - No belts, no gearing, no backlash
  - High servo stiffness

## ORDERING INFORMATION

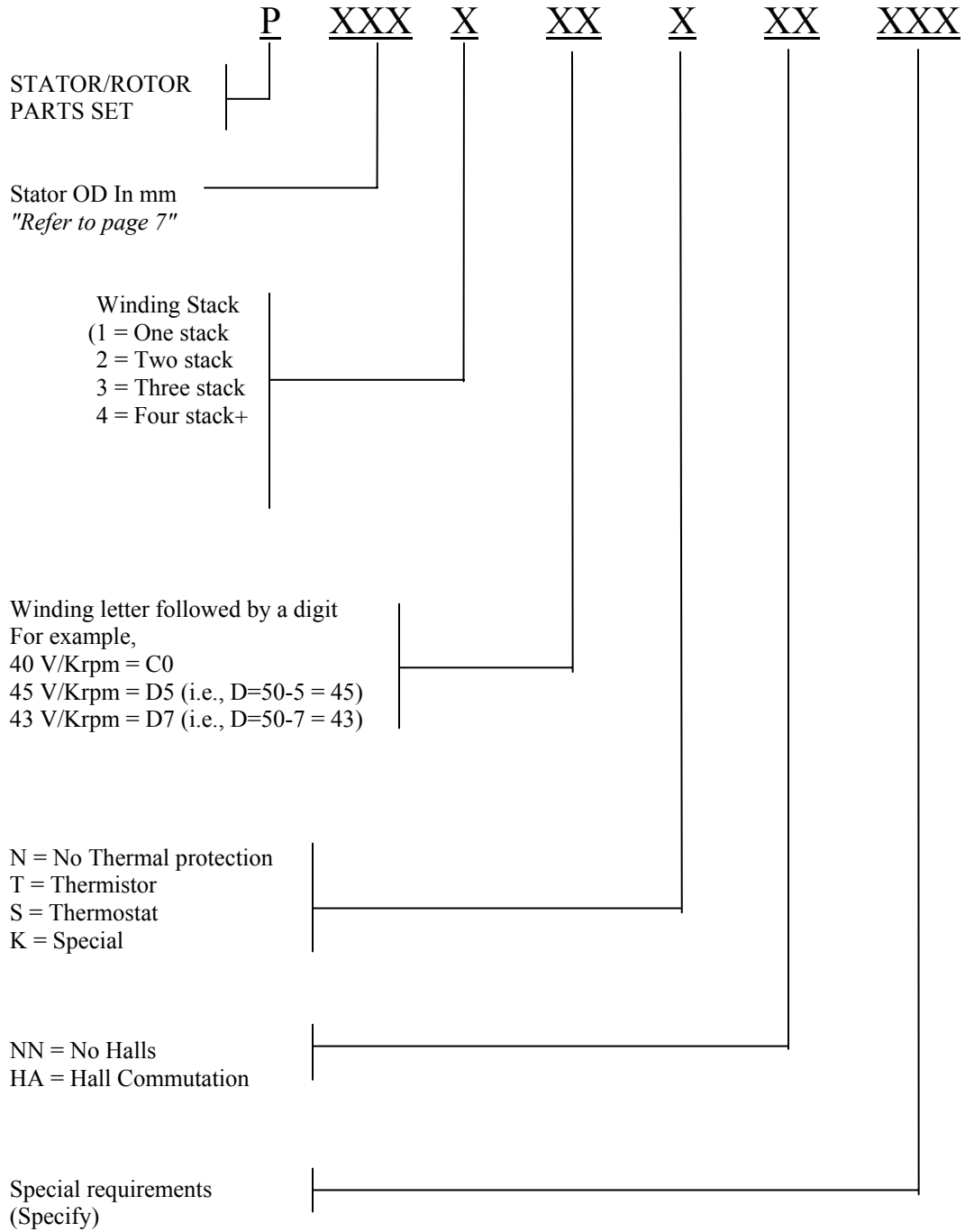

## **SAFETY**



Rare-Earth magnetic products should be handled with care. These magnets are very powerful and can accelerate at great speeds toward each other and toward ferrous material. When these magnets come together quickly, they can shatter and break sending particles at high speed. These magnets can also pinch strongly if allowed to come together against the skin. You should always wear gloves and eye protection when handling these strong magnets.

The strong magnetic fields of these magnets can damage magnetic media such as floppy disks, credit cards, magnetic I.D. cards, cassette tapes, video tapes or other such devices. They can also damage televisions, VCRs, computer monitors and other CRT displays. Never place neodymium magnets near electronic devices.

### **CAUTION!**

Never allow these magnets near a person with a pacemaker or similar medical aid. The strong magnetic fields of the magnet can affect the operation of such devices.

## **PACKAGING**

The various components are packaged in bubble wrap to assure that they remain separated during shipment. This also prevents damage during shipment.

### **UNPACKING**

In preparation for assembly, remove all components from the bubble wrap and be very careful to avoid damaging the components. Improper handling may substantially degrade motor performance.

The rotor is manufactured using very powerful and fragile Rare-Earth magnets. Do not place rotors close to another rotor, stator or near other ferromagnetic materials. The attractive forces of Rare-Earth magnets may cause damage to the components and/or bodily harm.

## **COMPONENT MOUNTING**

### **GENERAL**

The Direct Drive Set consists of a stator and a rotor. The stator may have a fully adjusted integrated commutation PCB assembly depending on the customer need. All stators are molded with thermally conductive epoxy for additional heat dissipation which also protects the stator winding and the commutation PCB assembly (when supplied) from physical damage.

## **STATOR**

The recommended installation procedure is to bond the stator to the housing using:

Loctite # 332 with activator # 7387/7380  
(or, Loctite #325 and activator # 7075)

...or equivalent. Follow adhesive manufacturer's recommendations during bonding procedure.

A shoulder should be provided in the housing for a positive stop and consistency in the assembly procedure. It is also important to radially align the stator with the rotor for best performance. Since the stator is molded with thermally conductive insulating material, there is no danger of grounding the stator to the housing.

The inside diameter of the housing should be 0.03 to 0.05 mm larger than the outside diameter of the stator. A large clearance between the inside diameter of the housing and outside diameter of the stator will result in an eccentric air gap, which will increase cogging torque, reduce motor performance and increase probability of failure due to the rotor striking the stator.

## **ROTOR**

The most common installation method is to permanently bond the rotor to the shaft using:

Loctite # 332 with activator # 7387/7380  
(or Loctite #325 and activator # 7075)

...or equivalent. Follow the adhesive manufacturer's instructions.

A shoulder on the shaft or the use of retaining ring(s) (Waldes Tru-Arc or equivalent) is recommended to establish a positive location for the rotor. Additionally, keying or other means may also be used to act as an anti-rotational device.

When bonding the rotor, the shaft diameter tolerance should be held to 0.03 to 0.05 mm below the minimum rotor diameter. A large clearance between the rotor and the shaft will result in an eccentric air gap, which will increase cogging torque, reduce motor performance and increase the probability of failure due to the rotor striking the stator.

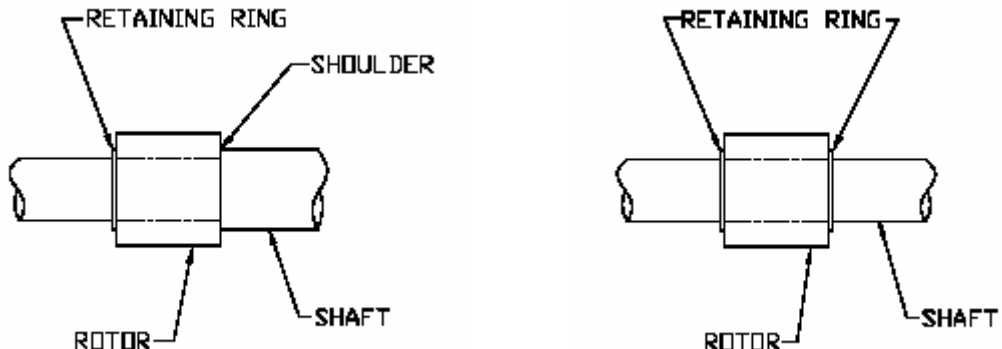

**PRODUCT DIMENSIONS**

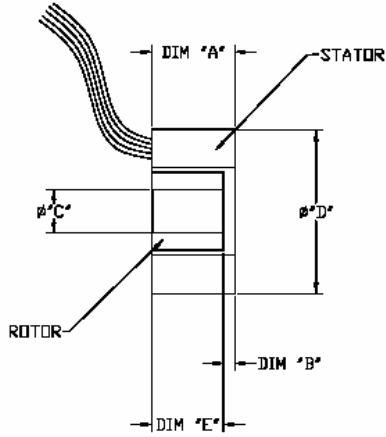

- A: Width of the stator
- B: Axial location of rotor with respect to the stator end opposite the leads
- C: Rotor inside diameter
- D: Stator outside diameter
- E: Width of rotor

Note:  
All dimensions below are in millimeters (mm)

Frame Size	Without Hall		Cmax	D	Without Hall E
	A	B			
P0551	39	6	16.00: +0.0 -0.074	55.00 +/- 0.038	21
P0552	58	6	16.00: +0.0 -0.074	55.00 +/- 0.038	40
P0553	77	6	16.00: +0.0 -0.074	55.00 +/- 0.038	60
P0554	96	6	16.00: +0.0 -0.074	55.00 +/- 0.038	81
P0631	30	4	28.95 +/- 0.038	60.35 +/- 0.038	15
P0632	43	4	28.95 +/- 0.038	60.35 +/- 0.038	28
P0633	56	4	28.95 +/- 0.038	60.35 +/- 0.038	42
P0634	69	4	28.95 +/- 0.038	60.35 +/- 0.038	55

Frame Size	Without Hall		Cmax	D	Without Hall E
	A	B			
P0811	38	6	32.00 +/- 0.038	81.28 +/- 0.038	20
P0812	55	6	32.00 +/- 0.038	81.28 +/- 0.038	37
P0813	72	6	32.00 +/- 0.038	81.28 +/- 0.038	58
P0814	89	6	32.00 +/- 0.038	81.28 +/- 0.038	73
P1051	61	10	31.75 +/- 0.038	105.00 +/- 0.038	32
P1052	92	10	31.75 +/- 0.038	105.00 +/- 0.038	63
P1053	123	10	31.75 +/- 0.038	105.00 +/- 0.038	95
P1054	154	10	31.75 +/- 0.038	105.00 +/- 0.038	126
P1271	32	7	63.50 +/- 0.05	127.00 +/- 0.075	13
P1272	42	7	63.50 +/- 0.05	127.00 +/- 0.075	23
P1273	52	7	63.50 +/- 0.05	127.00 +/- 0.075	33
P1274	62	7	63.50 +/- 0.05	127.00 +/- 0.075	45

P1431	55	10	38.05: +0.00 - 0.035	143.00 +/- 0.038	26
P1432	80	10	38.05: +0.00 - 0.035	143.00 +/- 0.038	51
P1433	105	10	38.05: +0.00 - 0.035	143.00 +/- 0.038	76
P1434	130	10	38.05: +0.00 - 0.035	143.00 +/- 0.038	101

## ASSEMBLY PRECAUTIONS

When assembling the rotor into the stator, high radial and axial forces will be experienced. Proper precautions should be exercised during assembly to avoid damage to the rotor. Although the rotor is protected with polymer shrink-wrap additional precaution may be required to avoid damage.

### **IMPORTANT NOTE:**

Always use certified outline drawings for best performance and trouble free assembly.

## SIGNAL TIMING

A Commutation PCB Assembly, when required, is fully preset at the factory. No additional adjustments are required.

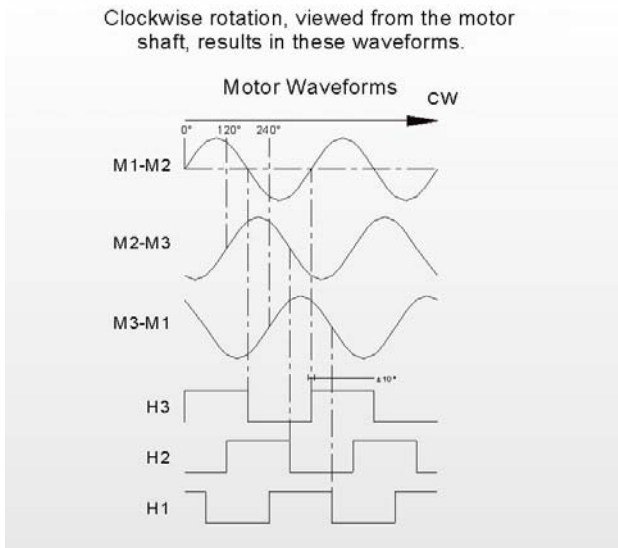

MOTOR WIRING CODE		
FROM	WIRE COLOR	WIRE SIZE
MOTOR M1	WHITE	18 AWG.
MOTOR M2	BLACK	18 AWG.
MOTOR M3	RED	18 AWG.

HALLS WIRING CODE		
FROM	WIRE COLOR	WIRE SIZE
+ 5 VDC	RED	26 AWG.
COMMON	BLACK	26 AWG.
H1	ORANGE	26 AWG.
H2	YELLOW	26 AWG.
H3	GREEN	26 AWG.

## BEARINGS

The bearing type and size shall be selected based on application requirement. Excessive friction will cause equal amount of performance loss.

